

# BAR-3002

## Heavy Duty Sway Bar Link

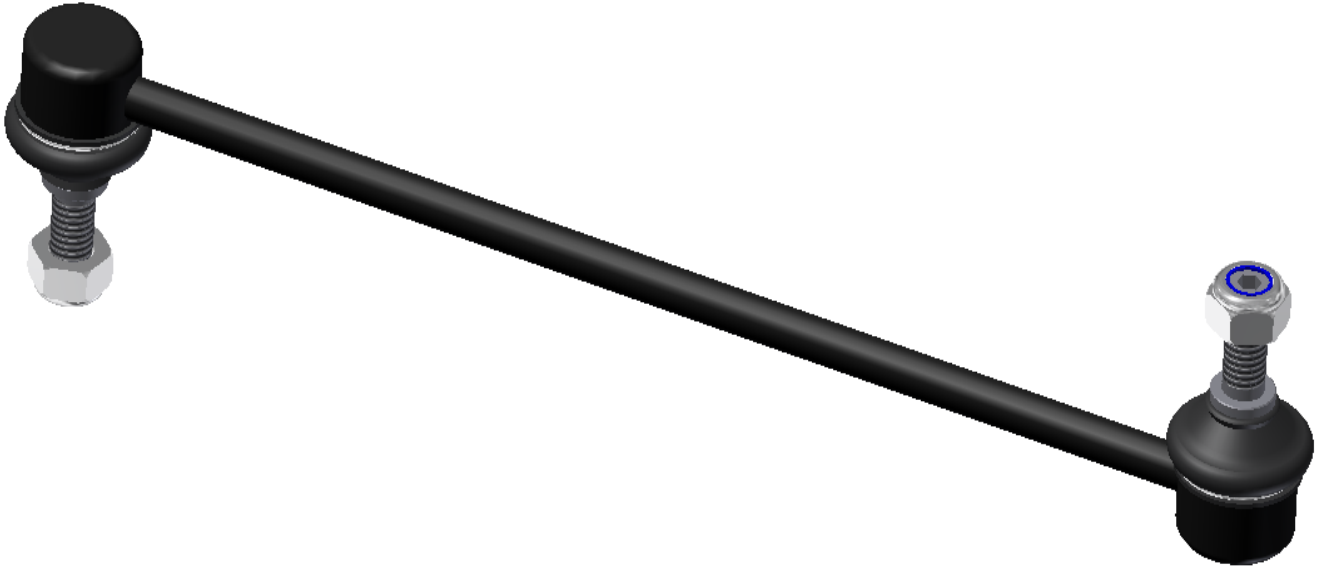

(2) Per Vehicle

| Napa #  | McQuay # | Moog # | TRW # | O.E.M    |
|---------|----------|--------|-------|----------|
| 2651633 | n/a      | K80252 | n/a   | 22670300 |

### APPLICATIONS:

| Year      | Make      | Model   | Location | Qty / Vehicle |
|-----------|-----------|---------|----------|---------------|
| 2013-2015 | FORD      | FUSION  | Front    | 2             |
| 2005-2011 | CHEVROLET | COBALT  | Front    | 2             |
| 2006-2011 | CHEVROLET | HHR     | Front    | 2             |
| 2004-2010 | CHEVROLET | MALIBU  | Front    | 2             |
| 2007-2010 | PONTIAC   | G5      | Front    | 2             |
| 2005-2010 | PONTIAC   | G6      | Front    | 2             |
| 2007-2009 | SATURN    | AURA    | Front    | 2             |
| 2003-2007 | SATURN    | ION     | Front    | 2             |
| 2000-2006 | CHEVROLET | ASTRA   | Front    | 2             |
| 2000-2006 | CHEVROLET | ZAFIRA  | Front    | 2             |
| 2005-2006 | PONTIAC   | PURSUIT | Front    | 2             |